

MINI PC PCG35

Quick Start Guide



Thanks for choosing MeLE

Packing List

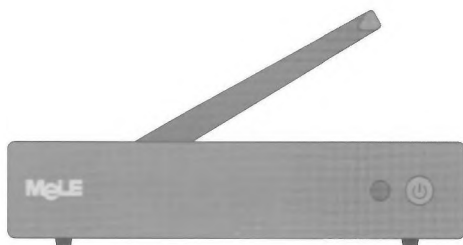

Mini PC



Power Adapter



GS



UK



US



SAA



Quick
Start Guide



SSD Silicone
Rubber

* Plugs are optional, depended on the sales regions.

Interface

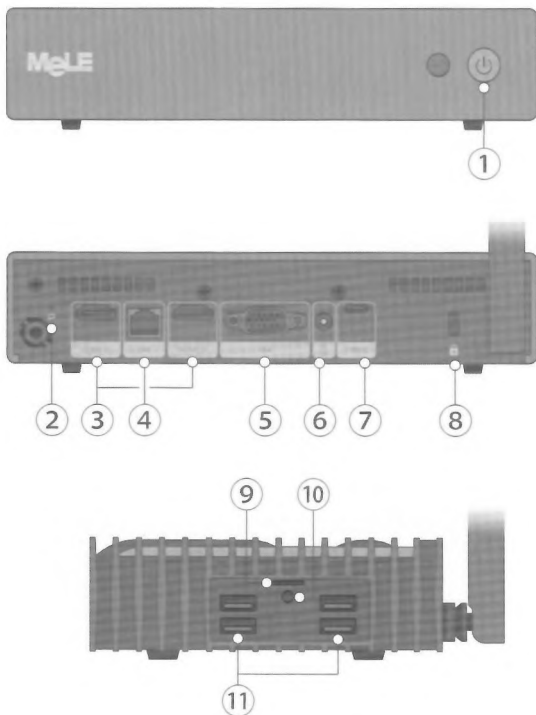

- | | |
|---------------------------------|--------------------------|
| ① Power Button | ⑥ Power input |
| ② Reset (CMOS Reset/BIOS Reset) | ⑦ USB Type- C |
| ③ HDMI Port *2 | ⑧ Kensington Lock Slot |
| ④ Gigabit Ethernet Port | ⑨ Micro SD Card Slot |
| ⑤ VGA Port | ⑩ 3.5mm Audio Combo Jack |
| | ⑪ USB 3.0 Ports *4 |



The picture is only used to describe the interface function of the product. In case of any deviation, the actual product shall prevail.

How to Connect

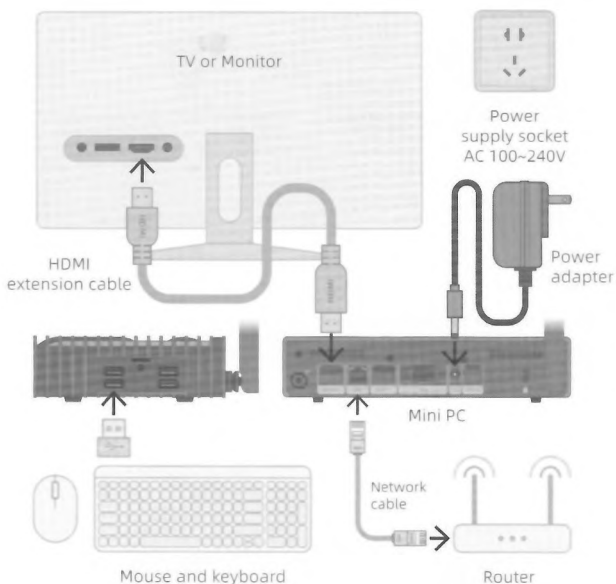

1. Connect the 12V power adapter to the Mini PC
2. Connect the Mini PC to a TV or monitor by HDMI extension cable
3. Turn on your Mini PC by pressing the power button
4. The LED indicator turns blue when you power on the Mini PC
5. Enjoy your Mini PC by connecting with keyboard and mouse

Install a M.2 SSD

1. Prepare a M.2 2280 SSD. And take off the four screws on the bottom panel to open the Mini PC.
2. Take off the screw on the PCB.
3. Install the M.2 SSD and fix the SSD with screw.
4. Put the silicone rubber on top of SSD for heat dissipation.
5. Fix the bottom panel with four screws.

Enter into BIOS Setting

Press the power button and press F7 or Delete on Keyboard continuously to enter select boot device menu -> select Enter

Reinstall Windows 10

Please visit MeLE official website -> Forum (<http://forum.mele.cn/>) or contact us to get the install steps and download link of Windows 10 image and device driver.



This equipment has been tested and found to comply with the limits for a Class B digital device, pursuant to Part 15 of the FCC Rules. These limits are designed to provide reasonable protection against harmful interference in a residential installation. This equipment generates uses and can radiate radio frequency energy and, if not installed and used in accordance with the instructions, may cause harmful interference to radio communications. However, there is no guarantee that interference will not occur in a particular installation. If this equipment does cause harmful interference to radio or television reception, which can be determined by turning the equipment off and on, the user is encouraged to try to correct the interference by one or more of the following measures:

- Reorient or relocate the receiving antenna.
- Increase the separation between the equipment and receiver.
- Connect the equipment into an outlet on a circuit different from that to which the receiver is connected.
- Consult the dealer or an experienced radio/TV technician for help.

Changes or modifications not expressly approved by the party responsible for compliance could void the user's authority to operate the equipment.

This device complies with part 15 of the FCC Rules. Operation is subject to the following two conditions: (1) This device may not cause harmful interference, and (2) this device must accept any interference received, including interference that may cause undesired operation.

Changes or modifications not expressly approved by the party responsible for compliance could void the user's authority to operate the equipment.

FCC Radiation Exposure Statement

This equipment complies with FCC radiation exposure limits set forth for an uncontrolled environment. This equipment should be installed and operated with minimum distance 20cm between the radiator & your body.

Mele Technologies (Shenzhen) Co., Ltd. holds the right to improve the appearance, dimension, color and technology of the product without prior notice.

All images on the giftbox and guide are for reference only, the physical product in the giftbox might be different.

Adapter shall be installed near the equipment and shall be easily accessible. The operating temperature of the device between 0°C to 35°C.

We declares that this device is in compliance with the essential requirements and other relevant provisions of Directive 2014/53/EU.

CAUTION: RISK OF EXPLOSION IF BATTERY IS REPLACED BY AN INCORRECT TYPE. DISPOSE OF USED BATTERIES ACCORDING TO THE INSTRUCTIONS.

Manufacturer: MeLE Technologies(Shenzhen) Co.,Ltd.

Address of Manufacturer: No.28 Cuijing Road, Pingshan District,Shenzhen(518118) P.R.China

Customer Email: meleservice@mele.cn

Website: www.mele.cn

